

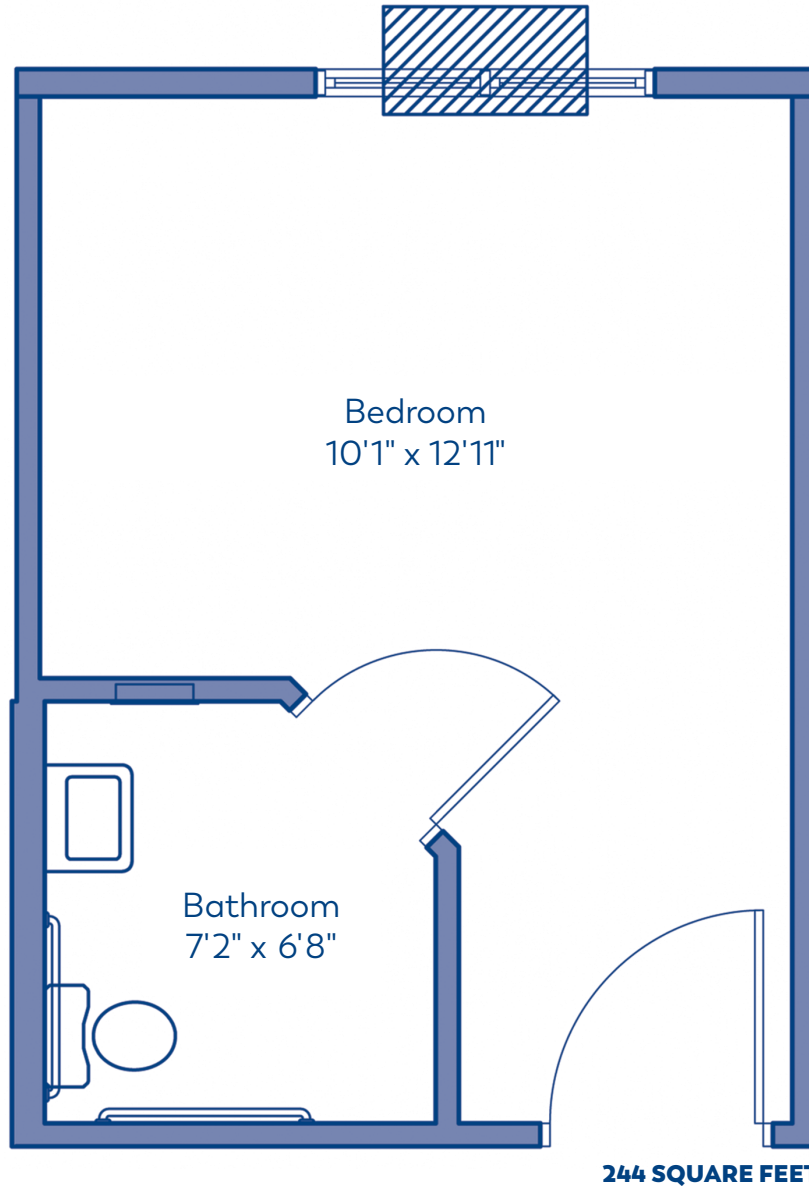

BUCKNER[®]
VILLAS

Inspiring happiness.[®]



THE HARBOR

MEMORY CARE - ONE BEDROOM



Serving
All Faiths



AL LICENSE #150005

INDEPENDENT LIVING | ASSISTED LIVING | MEMORY CARE | SKILLED NURSING
1110 TOM ADAMS DRIVE, AUSTIN, TEXAS 78753 | BUCKNERVILLAS.ORG | 512.836.1515

MEMORY CARE

Buckner Villas offers a wide range of services and amenities to make your life more convenient, comfortable, and enjoyable.

Person-Centered Care with a Home Like Environment

SERVICES

Three delicious meals each day
Medication administration and monitoring
Housekeeping and flat linen laundry service as needed
Personal laundry
Chaplain services available
All utilities (except telephone)
Scheduled weekday transportation to doctor appointments
Full schedule of life-enhancing activities
Apartment maintenance and repair
24-hour staffing
Music program
Mild to severe cognitive impairment
Assistance getting to/from dining room
Mealtime reminders
Assistance in bathing and dressing activities

SERVICES (continued)

Assistance with toileting activities
Assistance with meals
May provide altered food consistency
One person assistance with transfers
Mobility maintained with the use of a wheelchair
Hands on assistance and cueing to initiate and maintain ambulation
Re-direction and monitoring for safety
Re-direction to activities to facilitate participation

APARTMENT AMENITIES

Comfortable, private studio apartments
Wall-to-wall carpet and tile flooring
Individual heating and cooling controls

APARTMENT AMENITIES (Continued)

24-hour emergency response system
Private bathrooms with grab bars
Audio-visual fire alarm & sprinkler system

ACCOMMODATIONS

Attractive dining room
Home-like family room and activity areas
Landscaped grounds and outdoor patios
Beauty salon/Barber shop
Secured community
Pet therapy
Secure courtyard



Serving All Faiths



AL LICENSE #150005

INDEPENDENT LIVING | ASSISTED LIVING | MEMORY CARE | SKILLED NURSING
11110 TOM ADAMS DRIVE, AUSTIN, TEXAS 78753 | BUCKNERVILLAS.ORG | 512.836.1515